

DD28 Single Phase Watt-hours Meter

Application

DD28 single-phase watt-hour meter is a kind of induction meter, which is applicable to measure the rated frequency 50HZ~60HZ and power loss in electrified wire netting. All technical targets are completely conformed to National standard GB/T15283-94 and International standard IEC521.

Structure feature

The meter has separable electromagnet and the bearing has four kinds; single-jewel, dual jewel, magnetic thrust and magnetic floating. The case has three kinds; aluminum, plastic and glass. The die-casting frame is alloy aluminum with excellent mechanical strength.

Main technical data

Type	Accuracy(Class)	Rated Voltage (V)	Rated Current (A)	Overload Capacity	Starting Current	Insulation current
DD28	2	110 220~240	2(4), 2.5(5), 3(6), 5(10), 10(20), 20(40), 30(60),40(80)	200% Ib	0.5% Ib	AC voltage 2kV for 1 minute impulse voltage 6kV



DD28
glass cover
five digital



DD28
black plastic cover
five digital



DD28
transparent cover
five digital



DD28
aluminium cover
five digital



DD28
glass cover
six digital



DD28
black plastic cover
six digital



DD28
transparent cover
six digital



DD28
aluminium cover
six digital

Outer and mount dimension

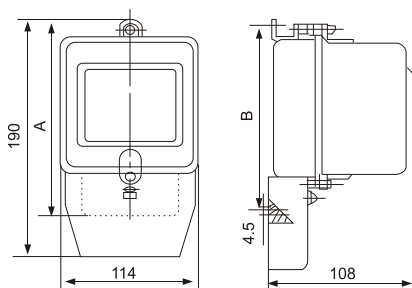

Imax>20A A=160mm B=147mm
Imax≤20A A=154mm B=142mm

DD28 Wiring diagram

